

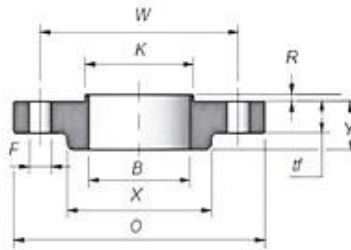

Flange Sobreposto (Slip-On) 900#



Item #	Diâmetro Nominal (Cota)	Diâmetro Externo (Ø)	Círculo de Furação (W)	Diâmetro Ressalto (K)	Espessura da Aba min WN, SW, SO - RF e FF, CE e TH (tf)	Espessura da Aba - Solto min LJ (tf)	Altura do Ressalto mm (R)	Altura do Ressalto in POL (R)
Ø120"	1/2	120	82.6	34.9	22.3	22.3	7	6.35
Ø130"	3/4	130	88.9	42.9	25.4	25.4	7	6.35
Ø150"	1	150	101.6	50.8	28.6	28.6	7	6.35
Ø160"	1.1/4	160	111.1	63.5	28.6	28.6	7	6.35
Ø180"	1.1/2	180	123.8	73.0	31.8	31.8	7	6.35
Ø215"	2	215	165.1	92.1	38.1	38.1	7	6.35
Ø245"	2.1/2	245	190.5	104.8	41.3	41.3	7	6.35
Ø240"	3	240	190.5	127.0	38.1	38.1	7	6.35
Ø290"	4	290	235.0	157.2	44.5	44.5	7	6.35
Ø350"	5	350	279.4	185.7	50.8	50.8	7	6.35
Ø380"	6	380	317.5	215.9	55.6	55.6	7	6.35
Ø470"	8	470	393.7	269.9	63.5	63.5	7	6.35
Ø545"	10	545	469.9	323.8	69.9	69.9	7	6.35
Ø610"	12	610	533.4	381.0	79.2	79.2	7	6.35
Ø640"	14	640	558.8	412.8	85.9	85.9	7	6.35
Ø705"	16	705	616.0	469.9	88.9	88.9	7	6.35
Ø785"	18	785	685.8	533.4	101.6	101.6	7	6.35
Ø855"	20	855	749.3	584.2	108.0	108.0	7	6.35
Ø1040"	24	1040	901.7	692.2	139.7	139.7	7	6.35